

ITEM	PART NO.	DESCRIPTION
1	AFQDD-8-1	UPPER AND LOWER ASSEMBLY
2	AFQDD-8-1A	LOWER ASSEMBLY

REVISIONS		
REV.	DESCRIPTION	DATE
NC	INITIAL RELEASE	03/14/2017
A	ADDED DIAMETER AND HEIGHT DIMENSIONS	03/21/2017
B	ADDED MS20004-(X) AS ALT INSTALLATION HARDWARE	06/08/2017

AFQDD-8-1 UPPER AND LOWER ASSY

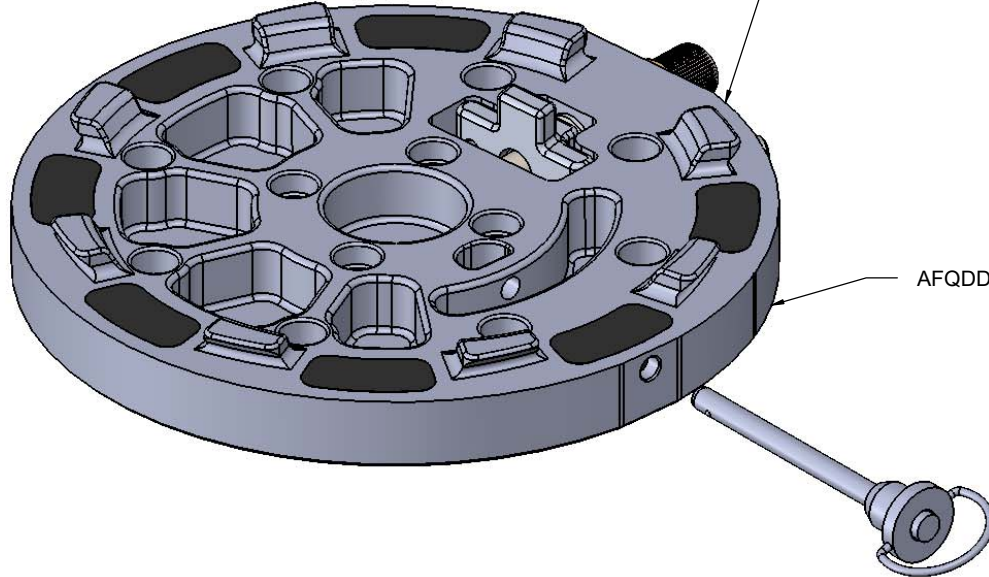
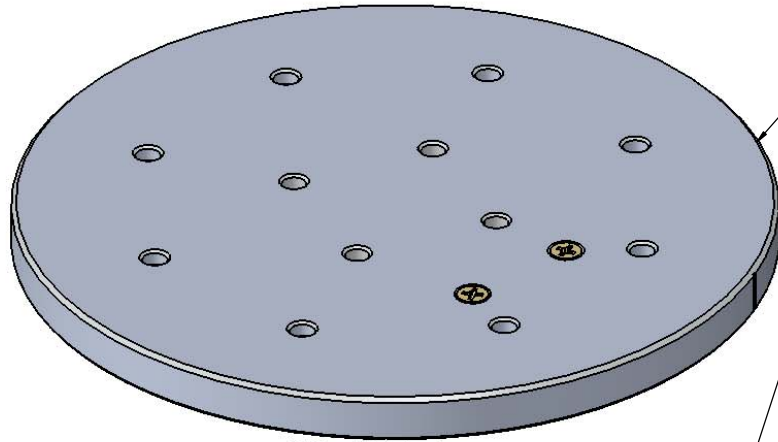

AFQDD-8-1A LOWER ASSY

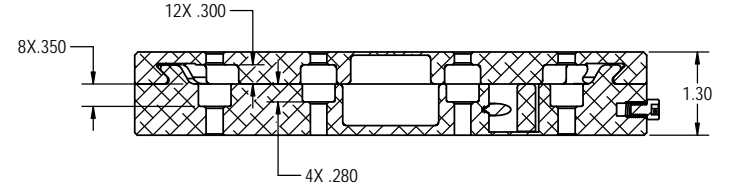
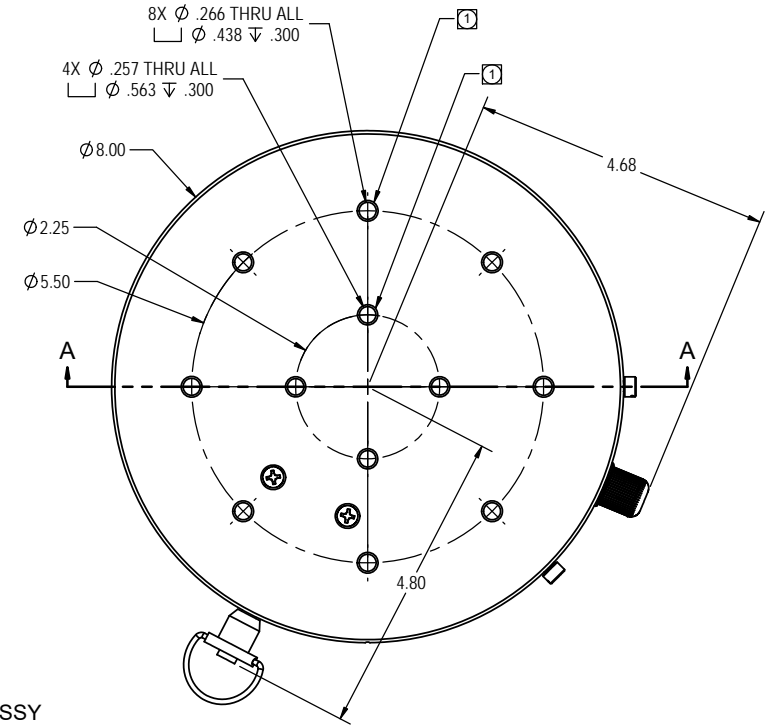

GENERAL DIMENSIONS

NOTES:

- ① LOWER QDD HOLE PATTERN TYP TO UPPER QDD (UPPER SHOWN). REFER TO SECTION VIEW FOR COUNTERBORE DEPTH DIMENSIONS.

UNLESS OTHERWISE NOTED ALL DIMENSIONS ARE IN INCHES

TOLERANCES:  
 X  $\pm$  .1  
 XX  $\pm$  .03  
 XXX  $\pm$  .010  
 ANGULAR:  $\pm$  .5°  
 BREAK ALL SHARP EDGES .015 MAX

DRAWING

	NAME	DATE
DRAWN	C. BROUCEK	03/14/2017
CHECKED	J. SANDOVAL	03/14/2017
APPROVED	C. MEEKER	03/14/2017

PROPRIETARY NOTICE

THIS DRAWING AND SPECIFICATION IS THE PROPERTY OF AIRFILM CAMERA SYSTEMS, INC AND SHALL NOT BE COPIED OR DIVULGED IN WHOLE OR IN PART AS THE BASIS FOR MANUFACTURING OR SALE OF THE ITEM OR ITEMS DISCLOSED.

**Airfilm Camera Systems**  
 www.airfilm.com Georgetown CA



TITLE: QDD-8 GENERAL INFO

SIZE	DWG. NO.	REV
C	AFQDD_8	B
SCALE 1:4	DO NOT SCALE DRAWING	SHEET 1 OF 2

THE AFQDD-8-1 ASSEMBLY IS A MECHANICAL INTERFACE TO ACCOMMODATE THE RAPID INSTALLATION / REMOVAL OF VARIOUS PAYLOADS. IT IS TO BE USED FOR PAYLOADS WITH A MAXIMUM WEIGHT OF 130LBS, AND IS MOST EFFECTIVE FOR VERTICAL LOADING APPLICATIONS, SUCH AS UAV AND OTHER CLOSE FITTING INSTALLATIONS. EXAMPLES OF OTHER INSTALLATIONS INCLUDE: FIXED WING AIRCRAFT, ROTORCRAFT, AIRSHIPS, GROUND AND WATER BASED VEHICLES.

**LIMITATIONS:**

- INSTALLED ON AIRCRAFT WITH VNE OF 425KTS OR LESS.
- DESIGN PAYLOAD WEIGHT: 130 LBS (CALL FOR MAX ALLOWABLES).
- LIMIT DRAG MOMENT: 28,300 IN-LBS
- SAFETY PIN MUST BE INSTALLED AND LOCKED PRIOR TO FLIGHT.
- AFQDD-8-1 WEIGHT 4.5 LBS (2.04 Kg)

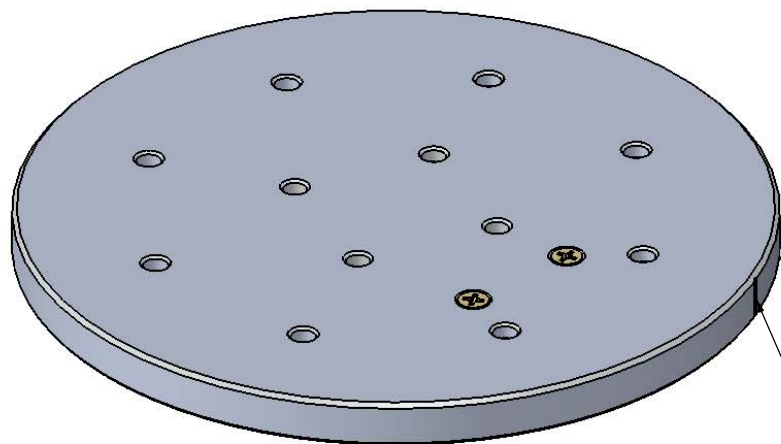

INSTALLATION OF THE UPPER QDD PLATE TO AIRCRAFT / ATTACHMENT MOUNT OR SENSOR (FOR SENSOR UP INSTALLATIONS) QTY 8 (MINIMUM) MS20004-(X), OR NAS1351-4-XX (OR EQVL BOLTS)  
REFER TO SHEET 1 FOR COUNTER BORE DEPTH TO DETERMINE THREAD LENGTH REQUIRED  
QTY A/R AN960-416 WASHER AND QTY A/R MS21042-4 STOP NUTS OR EQUIVALENT HARDWARE AS REQUIRED.

THE UPPER QDD HAS MULTIPLE THROUGH HOLES TO ACCOMMODATE VARIOUS BOLT PATTERNS. (SEE SHEET 1)  
NOTE: HARDWARE MUST BE RECESSED IN COUNTER BORE. BOLTS MAY BE INSTALLED THREADS UP IF REQUIRED

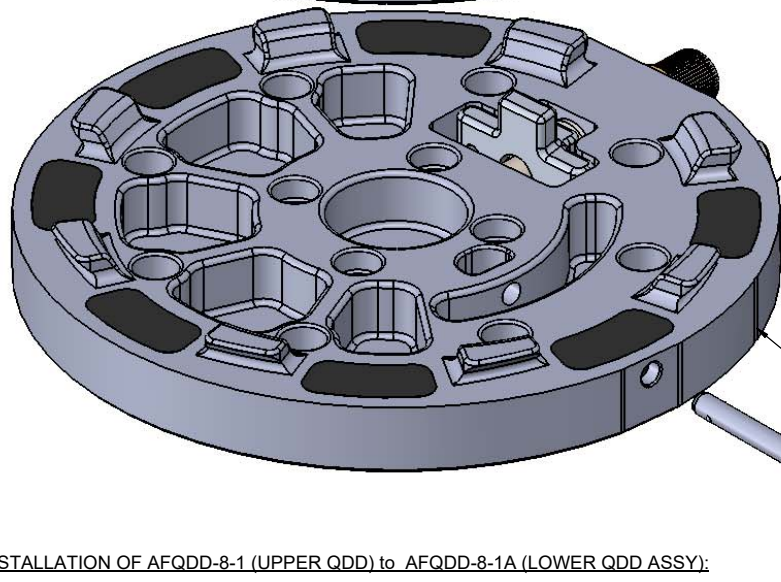

INSTALLATION OF THE AFQDD-8-1A (LOWER QDD ASSY ) TO SENSOR OR ATTACHMENT MOUNT (FOR SENSOR UP INSTALLATIONS) QTY 8 (MINIMUM) MS20004-(X), OR NAS1351-4-XX (OR EQVL BOLTS)  
REFER TO SHEET 1 FOR COUNTER BORE DEPTH TO DETERMINE THREAD LENGTH REQUIRED  
QTY A/R AN960-416 WASHER AND QTY A/R MS21042-4 STOP NUTS OR EQUIVALENT HARDWARE AS REQUIRED.

AFQDD-8-1A HAS MULTIPLE THROUGH HOLES TO ACCOMMODATE VARIOUS BOLT PATTERNS. (SEE SHEET 1)  
NOTE: HARDWARE MUST BE RECESSED IN COUNTER BORE. BOLTS MAY BE INSTALLED THREADS UP IF REQUIRED

**INSTALLATION OF AFQDD-8-1 (UPPER QDD) to AFQDD-8-1A (LOWER QDD ASSY):**

- ALIGN THE UPPER AND LOWER PARTS
- VERTICALLY ATTACH LOWER ASSY BY RISING INTO MATING CONNECTION AND TURNING CLOCKWISE APROX 30 DEG. (ENSURE ALIGNMENT MARKS ARE IN LINE ①)
- INSTALL QUICK-PIN (ENSURE PIN IS FULLY ENGAGED AND LOCKED) - DO NOT HAMMER OR FORCE PIN
- HAND TIGHTEN DRIVE KNOB (QDD-8-40) CLOCKWISE TO LOCK AND SECURE -
  - 1/4 HEX KEY DRIVE SOCKET PROVIDED FOR SETTING TORQUE ( 50 IN LBS MAX) -DO NOT OVER TORQUE
  - A SAFETY WIRE HOLE IS PROVIDED IN DRIVE KNOB IF ADDITIONAL SECURITY IS REQUIRED
- ENSURE NO FREE PLAY EXISTS

<b>Airfilm Camera Systems</b> www.airfilm.com    Georgetown CA			
TITLE: <b>QDD-8 GENERAL INFO</b>			
SIZE <b>C</b>	DWG. NO. <b>AFQDD_8</b>	REV <b>B</b>	
SCALE NA	DO NOT SCALE DRAWING	SHEET 2 OF 2	